



PISTON PUMPS

**LIST PRICE
CALL FOR DISCOUNTS!**

5300 Series Small Twin Piston Pumps Max. Temperature Is 140 F.



Model Number	Max. GPM	Max. PSI	Max. RPM	Description	List Price	Estimated Shpg. Wt.
5315C-HX 5315C-HRX 5315C-CHX	1.5	500	1800	Cast iron pumps with torque arm, 5/8" ID hollow shaft, 1/2" NPT ports, 140° F maximum temp. Cup material: HX (leather), HRX (Buna-N), CHX (Teflon).	\$361.00 361.00 388.00	10 lbs.
5320C-HX 5320C-HRX 5320C-CHX	2.0	500	1800	Cast iron pumps with torque arm, 5/8" ID hollow shaft, 1/2" NPT ports, 140° F maximum temp. Cup material: HX (leather), HRX (Buna-N), CHX (Teflon).	\$361.00 361.00 388.00	10 lbs.
5325C-HX 5325C-HRX 5325C-CHX	2.5	500	1800	Cast iron pumps with torque arm, 5/8" ID hollow shaft, 1/2" NPT ports, 140° F maximum temp. Cup material: HX (leather), HRX (Buna-N), CHX (Teflon).	\$361.00 361.00 388.00	10 lbs.
5330C-HX 5330C-HRX 5330C-CHX	3.0	500	1800	Cast iron pumps with torque arm, 5/8" ID hollow shaft, 1/2" NPT ports, 140° F maximum temp. Cup material: HX (leather), HRX (Buna-N), CHX (Teflon).	\$361.00 361.00 388.00	10 lbs.



Model Number	Max. GPM	Max. PSI	Max. RPM	Description	List Price	Estimated Shpg. Wt.
5315C-X 5315C-RX 5315C-CX	1.5	500	1800	Cast iron pumps with base, 5/8" OD solid shaft, 1/2" NPT ports, 140° F maximum temp. Cup material: X (leather), RX (Buna-N), CX (Teflon).	\$361.00 361.00 388.00	10 lbs.
5320C-X 5320C-RX 5320C-CX	2.0	500	1800	Cast iron pumps with base, 5/8" OD solid shaft, 1/2" NPT ports, 140° F maximum temp. Cup material: X (leather), RX (Buna-N), CX (Teflon).	\$361.00 361.00 388.00	10 lbs.
5325C-X 5325C-RX 5325C-CX	2.5	500	1800	Cast iron pumps with base, 5/8" OD solid shaft, 1/2" NPT ports, 140° F maximum temp. Cup material: X (leather), RX (Buna-N), CX (Teflon).	\$361.00 361.00 388.00	10 lbs.
5330C-X 5330C-RX 5330C-CX	3.0	500	1800	Cast iron pumps with base, 5/8" OD solid shaft, 1/2" NPT ports, 140° F maximum temp. Cup material: X (leather), RX (Buna-N), CX (Teflon).	\$361.00 361.00 388.00	10 lbs.



Add suffix "D" to pump model for injector head - example 5320C-DRX - add \$50.00

Model Number	Max. GPM	Max. PSI	Max. RPM	Description	List Price	Estimated Shpg. Wt.
5321C-H 5322C-H	2.2	1000	1800	Cast iron pumps with torque arm and Buna-N seals, 5/8" ID hollow shaft, 1/2" NPT ports, 180° F maximum temp. Plunger material: 5321 (stainless steel), 5322 (ceramic).	\$377.00 377.00	11 lbs.
5324C-H	2.9	800	1800	Cast iron pumps with torque arm and Buna-N seals, 5/8" ID hollow shaft, 1/2" NPT ports, 140° F maximum temp. Plunger material: stainless steel.	377.00	11 lbs.



Add suffix "D" to pump model for injector head - example 5320C-DH - add \$50.00

5300 Series Small Twin Plunger Pumps



Model Number	Max. GPM	Max. PSI	Max. RPM	Description	List Price	Estimated Shpg. Wt.
5321C 5322C	2.2	1000	1800	Cast iron pumps with torque arm and Buna-N seals, 5/8" OD solid shaft, 1/2" NPT ports, 180° F maximum temp. Plunger material: 5321 (stainless steel), 5322 (ceramic).	\$383.00 383.00	11 lbs.
5324C	2.9	800	1800	Cast iron pumps with torque arm and Buna-N seals, 5/8" OD solid shaft, 1/2" NPT ports, 140° F maximum temp. Plunger material: stainless steel.	383.00	11 lbs.

Add suffix "D" to pump model for injector head - example 5321C-D - add \$50.00

Model Number	Max. GPM	Max. PSI	Max. RPM	Description	List Price	Estimated Shpg. Wt.
53702 53703*	2.2 2.3	1000	3450 3100	Cast iron pumps with torque arm and Buna-N seals and ceramic plungers. 5/8" ID hollow shaft, 1/2" NPT ports, 180° F maximum temp.	\$383.00 383.00	11 lbs. 11 lbs.



PISTON PUMPS



5321 & 5322 PLUNGER PUMP PARTS

Ref. No.	Mfg. Part No.	Quan.	Description
2	Available In Kit Only		(See Listing To Right)
3	Available In Kit Only		(See Listing To Right)
4	1830-0056	2	Retainer
5	Available In Kit Only		(See Listing To Right)
6	1830-0054	2	Seal Retainer
7	Available In Kit Only		(See Listing To Right)
8	Available In Kit Only		(See Listing To Right)
9	Available In Kit Only		(See Listing To Right)
10	Available In Kit Only		(See Listing To Right)
11	1830-0053	2	Guide Retainer
12	3500-0021	2	Plunger
13	0502-5300	1	Connecting Rod
14	0608-5300	1	Safety Cover
15	2210-0063	*	Head Bolt (8 Req'd Model 5321C-H Hollow ... shaft pump, 4 bolts req'd for top head only on Model 5321C solid shaft pump)
15A	2210-0064	4	Extra Long Head Bolt for securing mounting .. base to Model 5321C solid shaft pump
16	0201-5300C	2	Cylinder Head
17	1720-0038	2	O Ring for Cylinder Head
18	3400-0073	4	Valve Assembly
19	0108-5300C	1	Body (Cast Iron)
21	2405-0006	1	Grease Fitting
22		1	Hollow Shaft Sub. Assem. (See Listing To Right)
25	1610-0011	1	Spline Key For Hollow Shaft
26		1	Solid Shaft Sub. Assem. (See Listing To Right)
27	1610-0007	1	Spline Key for Solid Shaft
28	2130-0007	1	Shield
29	2008-0001	2	Main Bearing
30	1810-0013	2	Retainer Ring (Shaft)
32	1510-0041	1	Mounting Base for No. 5321C (Solid Shaft)

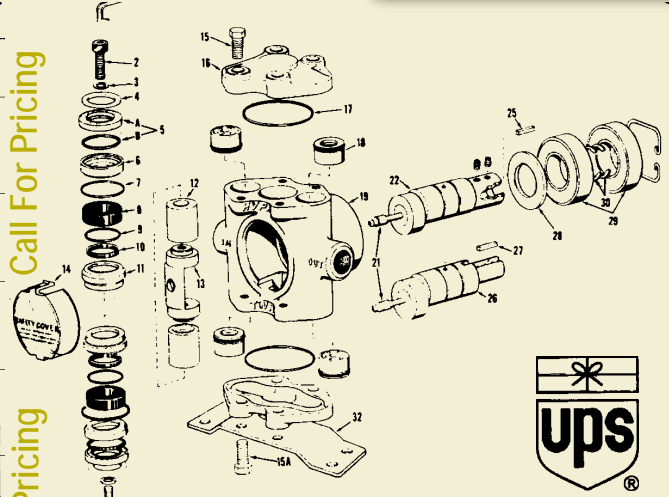

Call For Pricing

Call For Pricing



Plunger Stack Kit #3430-0144 Consists of 2-Guides, 4-O rings, 2-Seal assemblies, 2-Capscrews & 2-washers \$ 34.00

Plunger Parts Kit #3430-0145 Consists of 1-plunger stack kit & 2-plungers \$ 34.00

CRANK SHAFT KITS AVAILABLE are the following part #s
5001-5321, 5000-5321, 5501-5321 & 5500-5321, Please Inquire.

\$ Pricing Not Available at time of printing -Please Call! \$Use HYPRO'S List Price, if available to you.

5300 SMALL TWIN PISTON PUMP PARTS

Ref. No.	Mfg. Part No.	Quan.	Description
4	1830-0017	2	Piston Cup Spreader
5	1410-0030	2	Cup Backing Plate
6		1	Piston Stack Parts Kit-See Listing To The Right
7	1440-0004	2	Piston Guide
8	0502-5300	1	Connecting Rod
9	0608-5300	1	Safety Cover
10	2405-0006	1	Grease Fitting Assembly
12			Crankshaft Assemblies-Hollow Shaft Models, See Listing To Right
14	1610-0011	1	Spline Key for Hollow Shaft
15			Crankshaft Assemblies-Solid Shaft Models, See Listing To Right
16	1610-0007	1	Spline Key for Solid Shaft
18	0200-5300C	2	Cylinder Head
*18	0204-5300C	2	Cylinder Head (X Series Pumps)
19	1720-0038	2	O Ring For Cylinder Head
20	3550-0019	2	Cylinder Sleeve Assembly
21	3400-0073	4	Unitized Valve
*22	0108-5300C	1	Body (X Series Pumps)
24	2130-0007	1	Bearing Shield
25	2008-0001	2	Main Bearing
26	1810-0013	2	Bearing Retainer
28	1510-0022	1	Mounting Base
*28	1510-0056	1	Mounting Base (X Series Pumps)

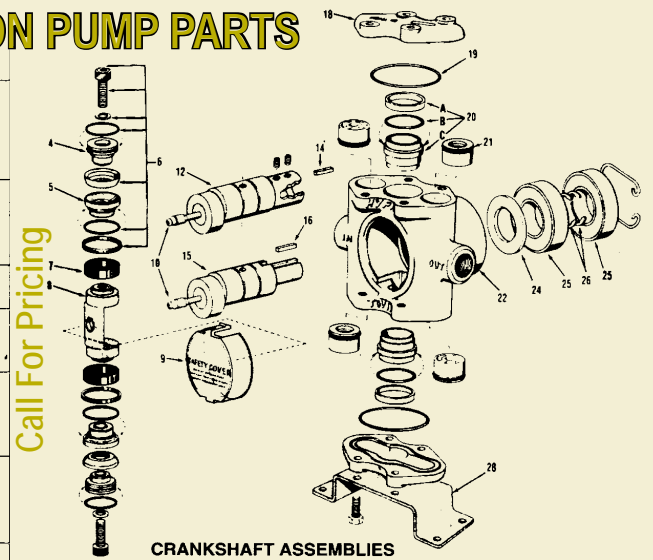

Call For Pricing

CRANKSHAFT ASSEMBLIES

SUB-ASSEMBLIES—Include Shaft (Ref. 12 or 15) with Cam Bearing, Grease Fitting Assembly (Ref. 10), Crankpin Retainer (Ref. 11), Set Screws for Hollow Shaft (Ref. 13) and Spline Key (Ref. 14 or 16).

COMPLETE ASSEMBLIES—Include the Sub-Assembly plus parts identified by Reference Numbers 24-26.

PISTON STACK PARTS KITS

Leather Cup Kit No. 3430-0007.....Call

Consists of two each of the following parts:
No. 2220-0012 Piston Cap Screw (Ref. 6A),
No. 2270-0011 Washer (Ref/ 6B), No. 1720-0029
O Ring (Ref. 6C), No. 2150-0002 Leather Cup
(Ref. 6D), No. 1720-0039 O Ring (Ref. 6E), and
No. 1440-0008 Seal Ring (Ref. 6F).

Rubber Cup Kit No. 3430-0009.....Call

Rubber Cup Kit No. 3430-0009: Same as above
kit except with No. 2150-0005 Rubber Cups.

Teflon Cup Kit No. 3430-0030.....Call

Teflon Cup Kit No. 3430-0030: Same as above kits
except with No. 2150-0011 Teflon Cups.

PISTON STACK AND GUIDE PARTS KITS

Leather Cup & Guide Kit No. 3430-0008...Call

Consists of Leather Cup Kit No. 3430-0007
plus two No. 1440-0004 Piston Guides (Ref. 7).

Rubber Cup & Guide Kit No. 3430-0010....Call

Consists of Rubber Cup Kit No. 3430-0009
plus two No. 1440-0004 Piston Guides.

Teflon Cup & Guide Kit No. 3430-0046.....Call

Consists of Teflon Cup Kit No. 3430-0030 plus
two No. 1440-0004 Piston Guides.

Sub-Assembly PART NO.	PRICE	Complete Assembly PART NO.		Pump Model Number
-with 5/8" (I.D.) Hollow Shaft (Ref. 12)				
5501-5315	82.75	5500-5315	\$ 94.25	5315H
5501-5320	80.50	5500-5320	90.25	5320H
5501-5325	103.50	5500-5325	114.00	5325H
5501-5330	99.50	5500-5330	112.00	5330H
-with 5/8" Solid Shaft (Ref. 15)				
5001-5315	103.00	5000-5315	131.25	5315
5001-5320	101.75	5000-5320	172.00	5320
5001-5325	78.00	5000-5325	85.50	5325
5001-5330	87.75	5000-5330	112.00	5330

